

# The Fleet

Our fleet of expedition ships are equipped with all necessary communication and navigation equipment. The officers and crew are highly experienced in ice navigation, and our Russian captains are recognized as world experts in polar operations. They are joined by our expedition staff and lecturers from all over the world – internationally renowned experts on a wide variety of subjects from marine mammals and birds to the history of polar exploration and geology. Professional chefs produce an excellent international menu, and the relaxing bars are well stocked with a good selection of beer, wine, and spirits.



B & C Alexander

## Former Scientific Research Vessels:

### *PROFESSOR MULTANOVSKIY, PROFESSOR MOLCHANOV & AKADEMIK SHOKALSKIY*

- Small vessels with a maximum of only 48 passengers
- Small size allows for a more intimate and spontaneous expedition venturing into areas closed to larger vessels
- Ice-strengthened hulls
- Experience a private expedition rather than a traditional cruise with maximum time ashore and a high staff-to-passenger ratio
- Relaxed and informal atmosphere on board
- Varied international menu

The *Professor Multanovskiy*, *Professor Molchanov*, and *Akademik Shokalskiy* are sister ships, built in Finland in 1982-83 for polar and oceanographic research. Continuously refurbished since their conversion for passenger use, they are ideally suited to expedition cruising. They carry a maximum of 48 passengers in comfortable twin and triple cabins - some with private facilities and others with shared facilities (there are ample shared facilities on deck 3). Each cabin has a window or porthole, a writing desk, and plenty of storage space.

Public areas include a lounge and well-stocked bar, a small library, infirmary, sauna, and dining rooms. Views are excellent from the large, open decks.

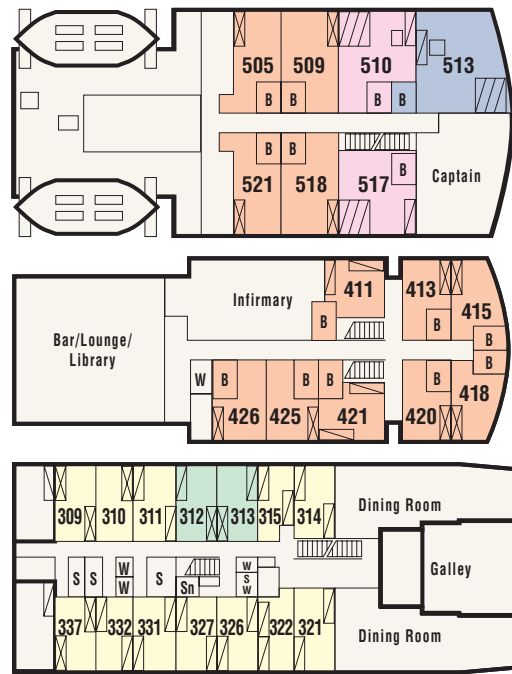

- Amundsen Suite
- Superior
- Twin
- Twin shared facilities
- Triple shared facilities
- ⊠ Lower berth
- ⊠ Upper & lower berths

## Specifications of *Professor Multanovskiy*, *Professor Molchanov* & *Akademik Shokalskiy*

Length.....69.7m	Ice Class.....UL
Breadth.....12.8m	Cruising Speed.....10 knots
Draft.....4.5m	Staff and Crew.....32
GRT.....1753 tons	Passengers.....48
Engines...2 Diesel ME, 3120 HP	Registry.....Russia



B & C Alexander

Akademik Shokalskiy



B & C Alexander

Professor Multanovskiy



B & C Alexander

Professor Molchanov



M/V Orlova / LOSCO

M/V Orlova

## The Expedition Cruise Ship: M/V ORLOVA

- Larger vessel with a maximum of 110 passengers
- Competitive pricing in a variety of accommodation options
- Spacious decks provide an excellent platform for wildlife viewing on sea crossings
- Ice-strengthened hull
- Relaxed and informal atmosphere on board
- Excellent cuisine prepared by professional chefs
- Comfortable amenities and spacious public areas

Built in Yugoslavia in 1976, refurbished in 1999, and further upgraded in 2002, the *M/V Orlova* is a 100-meter ice-strengthened passenger cruise ship. Accommodation on board ranges from twin and triple cabins to superior cabins and suites. They all have two lower berths and private facilities, a porthole or a window, as well as a writing desk, and ample storage.

Public areas include a spacious forward lounge and bar which also acts as a gathering place for lectures and recaps of the day's adventures, a window-lined dining room which accommodates all passengers in leisurely single seatings, an infirmary, and a well-stocked library. There are ample deck areas and promenades for excellent views of the passing scenery and wildlife.

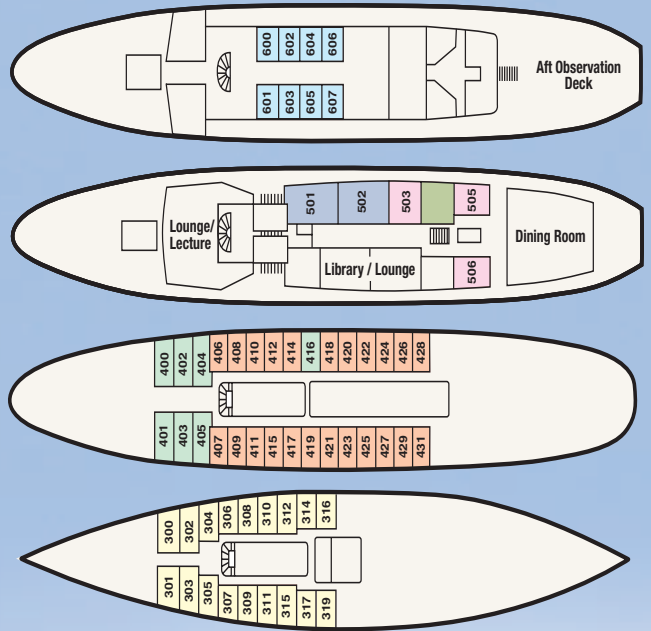

### Specifications of M/V Orlova

Length.....100.02m	Ice Class .....L3
Breadth.....16.24m	Cruising Speed .....12 knots
Draft.....4.65m	Staff and crew .....70
GRT .....4251 tons	Passengers.....110
Engines ....2 Diesel ME,5000 HP	Registry .....Malta

Amundsen Suite	Main Deck Twin
Superior	Lower Deck Twin
Captain's Deck Twin	Triple
Exercise Room	